



# OZB PINCH VALVES

## PRECISION CONTROL FOR SEAMLESS MATERIAL FLOW

Unlock the power of precision and reliability in material flow control with OZB Pinch Valves. Engineered to perfection, these valves are designed to limit or prevent the flow of materials in pipelines, setting the standard for efficiency and performance across a myriad of industries.



### KEY FEATURES

**Mechanical Simplicity:** OZB pinch valves boast a unique design with no mechanical parts that obstruct material flow when in the open position, ensuring a seamless and uninterrupted process.

**Versatile Applications:** Ideal for pneumatic transfer of powders or granules, OZB pinch valves find their place in various industries including food, chemicals, water treatment, cement, and more.

**Elastomer Excellence:** The heart of our pinch valves lies in the abrasion-resistant elastomer sleeve, crafted from a Staltic NR-BR-SBR composition, guaranteeing durability and longevity.

**Precision Control:** The working principle is ingenious — the elastomer sleeve is closed by blowing air between the sleeve and housing, directing powder flow with precision through the valve's opening once the air pressure is released.

**Customisation Options:** Tailor your OZB pinch valve to your specific needs with available add-ons like the PNVPLC Control Board and the PNVC100 Silotruck Connection Element.



ABN: 35 139 258 816

PO Box 111, Charlestown NSW 2290  
Unit 7/8 Kilcoy Drive, Tomago NSW 2322  
P: 1300 026 011 | E: [graham@bulkquip.com.au](mailto:graham@bulkquip.com.au)  
[www.bulkquip.com.au](http://www.bulkquip.com.au)

## PRODUCT SPECIFICATIONS

### PNV100 Pinch Valve

**Body:** Aluminium

**Sleeve:** Staltic NR-BR-SBR composition (Abrasion Resistant)

**Nominal Operating Pressure:** 4 bar (max)

**Max Control Pressure:** 6 bar

**Pressure Difference for Valve Closing  $\Delta P$ :** 1.5 bar

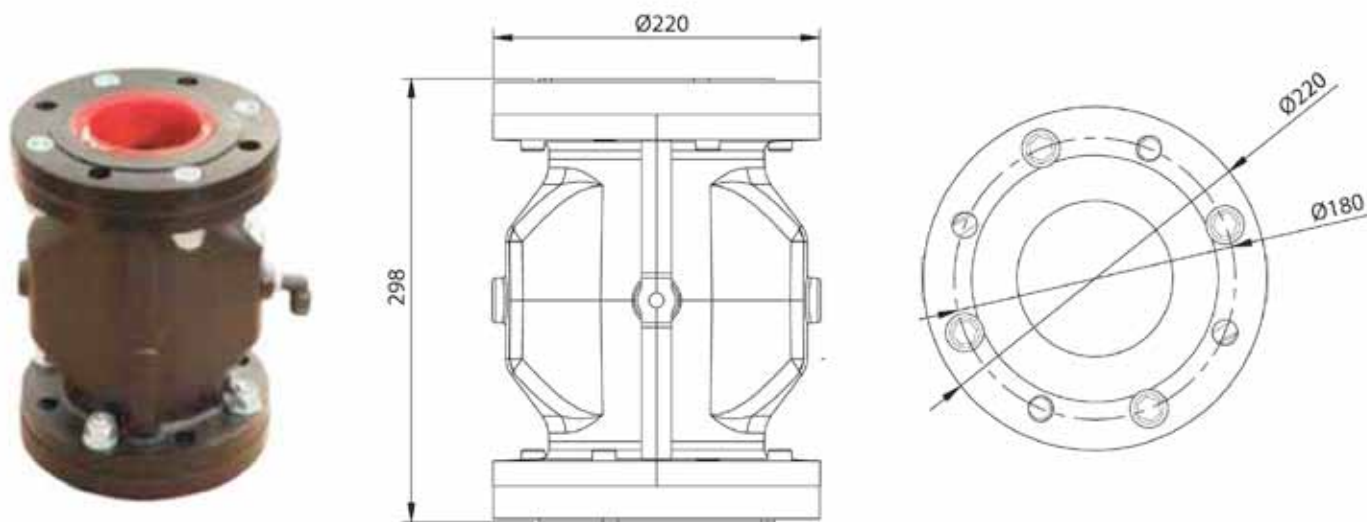

### PNVC100 Silotruck Connection Element

**Material:** Carbon Steel

**Mounting:** Before the pinch valve on the line

**Features:** Capacitive switch for signal generation, complete with bolts & nuts for assembly, additional flange for connection, and microswitch.

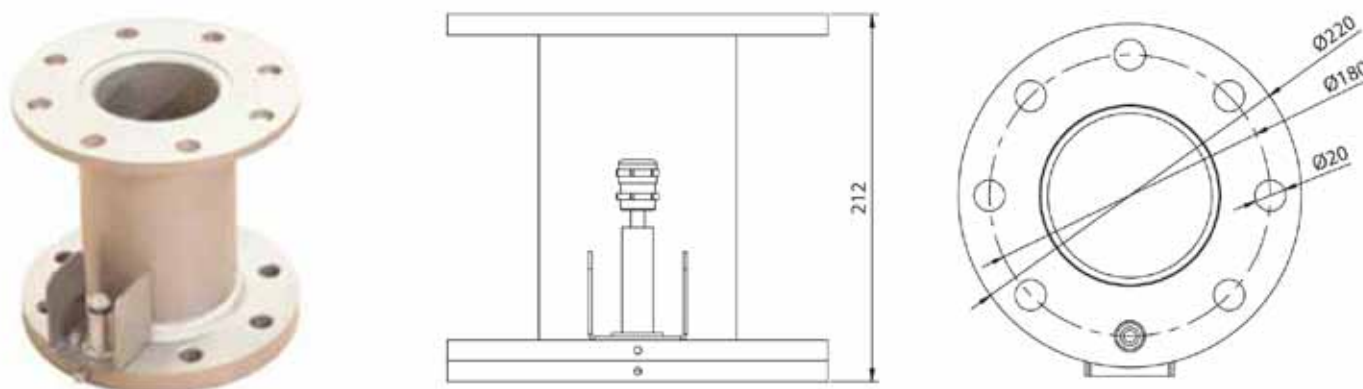

## PNVPLC Control Board

**Purpose:** Provides external air to the system for opening or closing the pinch valve under specific circumstances.



## Why Choose OZB Pinch Valves?

**Reliability:** Experience uninterrupted material flow with our mechanically simple yet robust design.

**Versatility:** Tailored for diverse applications in various industries.

**Durability:** The abrasion-resistant sleeve ensures long-lasting performance.

**Precision:** Control powder flow with unparalleled accuracy.

**Customisation:** Enhance functionality with optional Silotruck Connection Elements and Control Boards.