



# OZB ACTUATORS





# MANUAL ACTUATORS

Unlock the power of seamless valve control with OZB Manual Actuators. Our actuators are meticulously designed to govern the precise opening and closing of valves, providing you with unparalleled control and reliability in your operations.



## KEY FEATURES

### Versatile Compatibility

OZB actuators seamlessly integrate with both butterfly and slide valves, offering a comprehensive solution for your diverse valve control needs. Whether you're working with butterfly valves or slide valves, OZB has you covered.

### Manual, Pneumatic, and Electromotor Options

Choose the actuation method that suits your requirements. OZB Actuators are available in manual, pneumatic, and electromechanical types, ensuring flexibility and adaptability for your specific application.



ABN: 35 139 258 816

PO Box 111, Charlestown NSW 2290  
Unit 7/8 Kilcoy Drive, Tomago NSW 2322  
P: 1300 026 011 | E: [graham@bulkquip.com.au](mailto:graham@bulkquip.com.au)  
[www.bulkquip.com.au](http://www.bulkquip.com.au)

## ACM MANUAL ACTUATORS: TAILORED FOR BUTTERFLY VALVES

ACM Series manual levers are engineered with precision for optimal performance with butterfly valves. The electro-galvanized coated carbon steel frame not only ensures durability but also provides an ergonomic grip for effortless control via the EPDM Covered Handle.

### ACM13

Experience precision at its finest. The ACM13 is designed for use with butterfly valves ranging from 100-300mm in diameter. Achieve smooth and reliable valve control with this specialized manual actuator.

#### ACM13

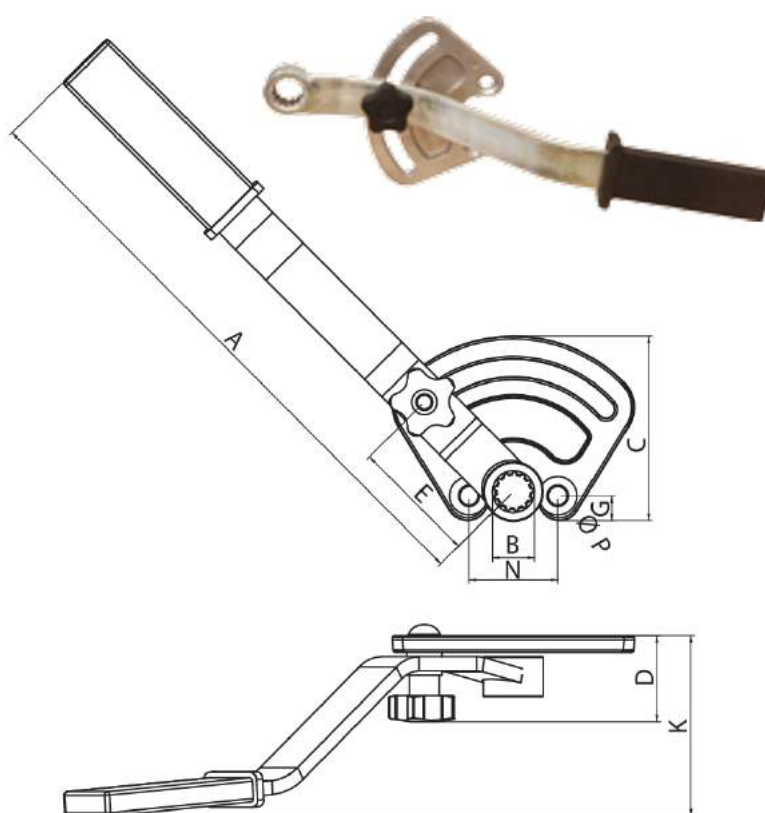

Type	A (mm)	B (mm)	C (mm)	D (mm)	E (mm)	G (mm)	N (mm)	P (mm)	K (mm)	Weight (kg)
ACM13	345	22x19	105	51	70	14	50	10,5	110	1.2

## ACM34

The ACM34 is designed for use with butterfly valves ranging from 350-400mm in diameter.

### ACM34

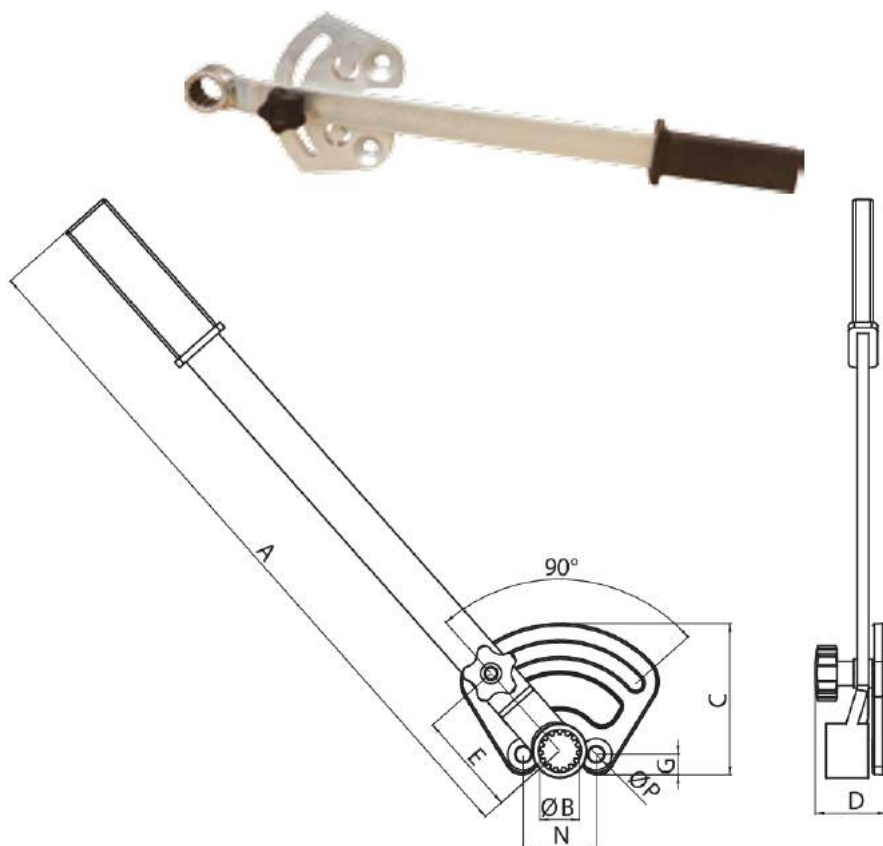

Type	A (mm)	B (mm)	C (mm)	D (mm)	E (mm)	G (mm)	N (mm)	P (mm)	Weight (kg)
ACM34	500	28x25	105	55	72	14	50	10.5	2.2

Embrace the power of precise valve control with OZB Manual Actuators. Contact us today to discover how our actuators can elevate the efficiency and reliability of your valve systems.

## ACMS SERIES MANUAL LEVERS

The ACMS series manual levers are manufactured specifically for slide valves, providing a trouble-free and durable service life.

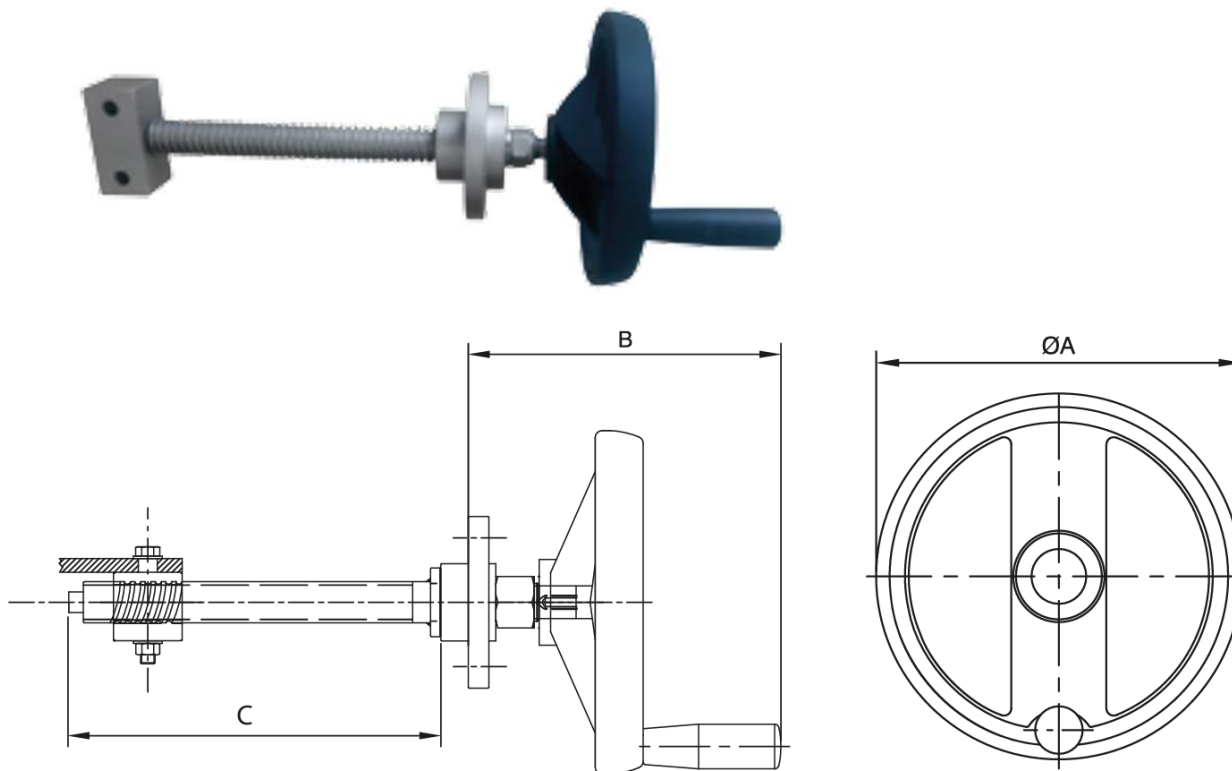

Type	ØA (mm)	B (mm)	C (mm)	Weight (kg)
ACMS150	200	180	190	2.0
ACMS200	200	180	230	2.4
ACMS250	200	180	285	2.8
ACMS300	200	180	335	3.0
ACMS350	250	220	425	5.2
ACMS400	250	220	470	5.8



# PNEUMATIC ACTUATORS

## PRECISION IN VALVE CONTROL

### Unlock Efficiency

Elevate your valve control with OZB Pneumatic Actuators, designed to flawlessly regulate the opening and closing of valves, ensuring optimal performance across diverse applications.

### Versatile Compatibility

Our actuators seamlessly couple with both butterfly and slide valves, offering a versatile solution for your control needs.

### Options Tailored to You

Choose from manual, pneumatic, and electromotor actuators, providing flexibility in accordance with your operational preferences.

## ACP PNEUMATIC ACTUATORS

### ACP13

- Ideal for 100-300mm diameter butterfly valves.
- Supplied with cramayer gear and piston set for precision control.



### ACP34

- Specially designed rod seal for extended service life and cost-effective operation.
- Double-acting piston and central assembly.
- Aluminium body construction.



## ACP13 PNEUMATIC ACTUATORS

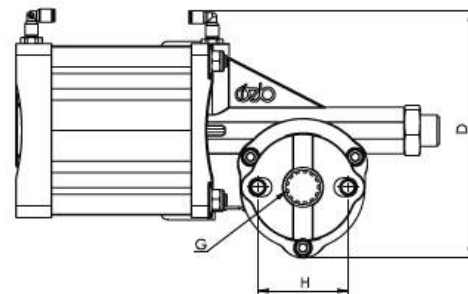
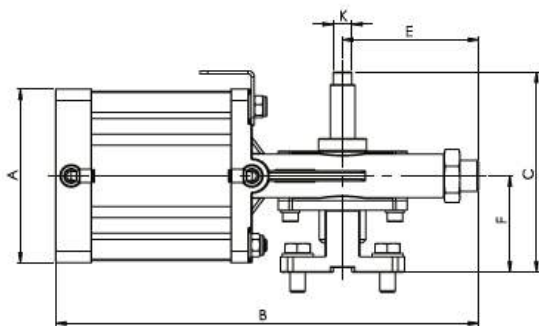

Type	A (mm)	B (mm)	C (mm)	D (mm)	E (mm)	G DIN 5482 (mm)	H (mm)	K (mm)	Air Consumption (cycle)	Weight (kg)
ACP13	112	275	130	165	86	22x19	58	12	4.4 (x2)	3.7

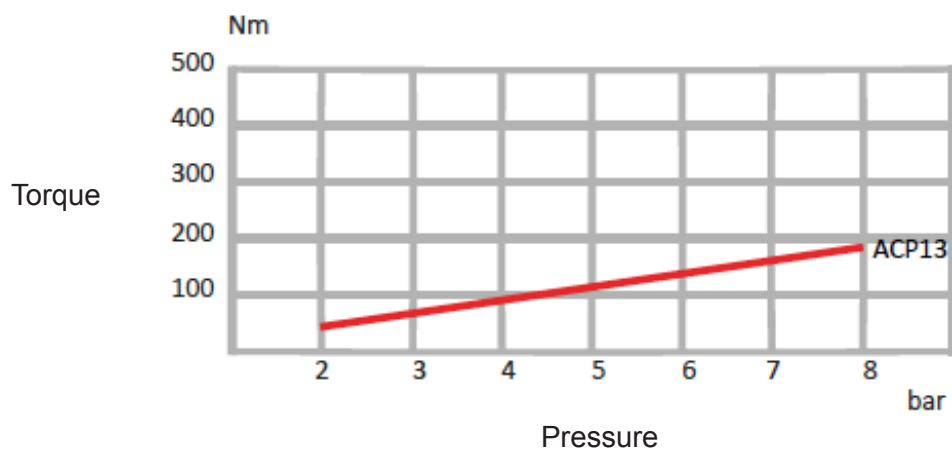

## ACP34 PNEUMATIC ACTUATORS

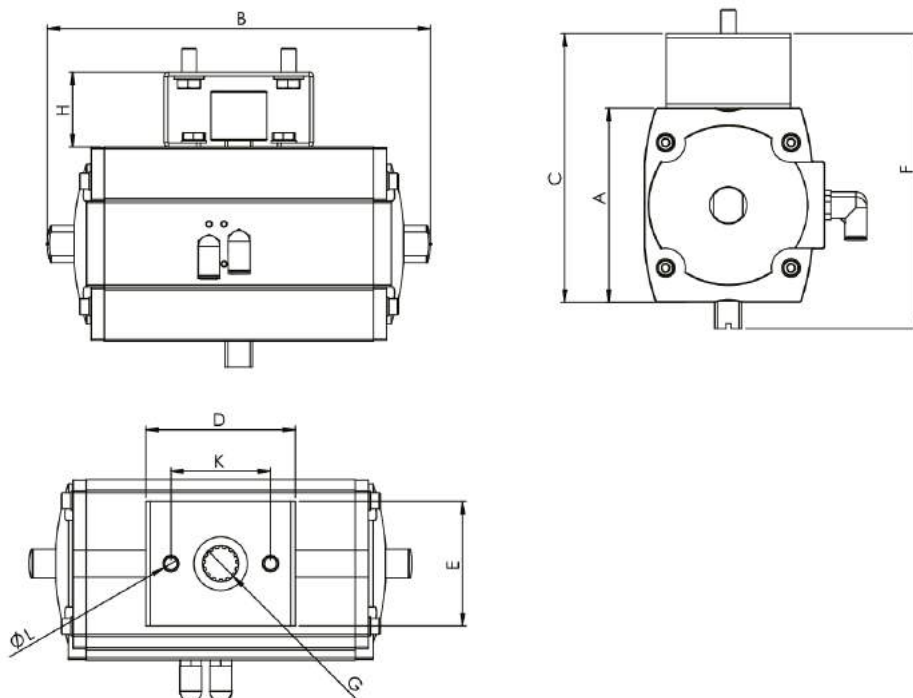

Type	A (mm)	B (mm)	C (mm)	D (mm)	E (mm)	F (mm)	G DIN 5482 (mm)	H (mm)	K (mm)	ØL (mm)	Air Consumption (cycle)	Weight (kg)
ACP34	156	310	216	120	100	237	28x25	60	80	13	7.1 (X2)	10

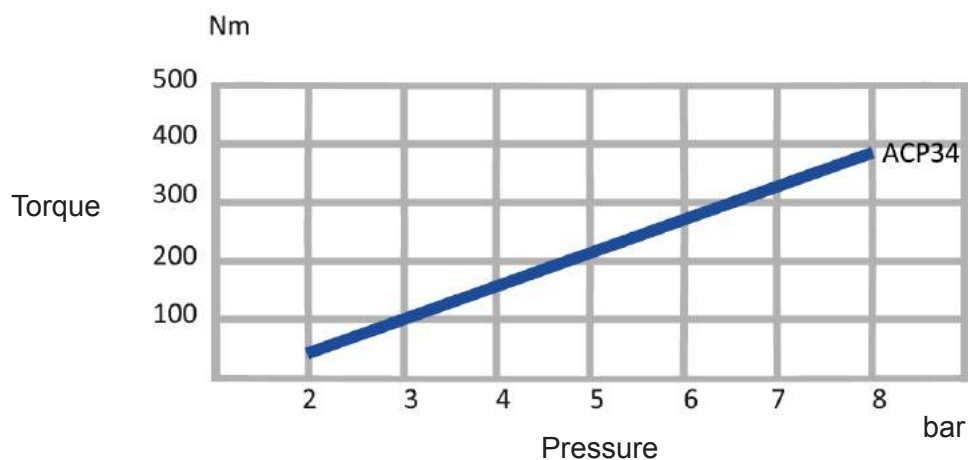



## ACPS PNEUMATIC ACTUATORS

The ACMS series manual levers are manufactured specifically for slide valves, providing a trouble-free and durable service life. Additionally, the ACPS series pneumatic actuators are designed for slide valves and come complete with pneumatic pistons and mounting elements.

### For Standard Applications

Type	Suitable Valve	ØPneumatic Cylinder (mm)	Stroke (mm)
ACPS150.63	SV.150	63	140
ACPS200.63	SV.200	63	190
ACPS250.63	SV.250	63	240
ACPS300.63	SV.300	63	290
ACPS350.80	SV.350	80	340
ACPS400.80	SV.400	80	385

### For Heavy Duty Applications

Type	Suitable Valve	ØPneumatic Cylinder (mm)	Stroke (mm)
ACPS150.80	SV.150	80	140
ACPS200.80	SV.200	80	190
ACPS250.80	SV.250	80	240
ACPS300.80	SV.300	80	290

### For Extra-Heavy Duty Applications\*

Type	Suitable Valve	ØPneumatic Cylinder (mm)	Stroke (mm)
ACPS300.100	SV.300	100	290
ACPS350.100	SV.350	100	340
ACPS400.100	SV.400	100	385

\* Adaptor Required

## MS MICROSWITCH

The OZB MS Microswitch is designed for detecting the physical motion of valve shafts. These microswitches come equipped with a single-piece cam, providing easy adjustment, and reducing the risk of adjustment failures

Microswitches are commonly used in various industrial applications where a physical motion or position needs to be detected. The use of a single-piece cam in the OZB MS Microswitches simplifies the adjustment process and enhances the reliability of the switch in maintaining its set position.



### KEY FEATURES

**Type:** OZB MS Microswitches

**Application:** Detection of the physical motion of valve shafts.

**Key Feature:** Single-piece cam design for easy adjustment and reduced risk of adjustment failures.

#### MS13

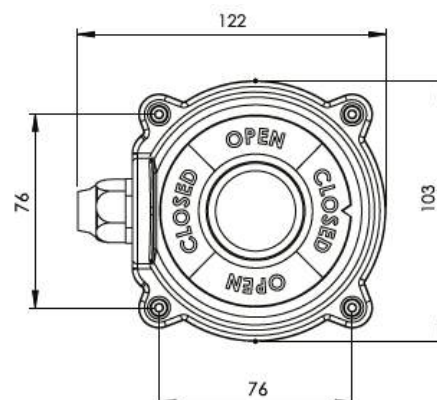
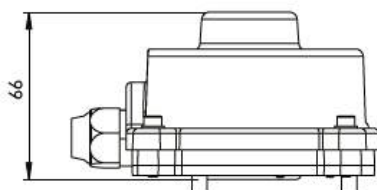

Designed for ACP13 pneumatic actuators.



# ELECTRIC MOTOR ACTUATORS

## YOUR ULTIMATE SOLUTION FOR PRECISE VALVE CONTROL!

Enhance the efficiency of your operations with ACES series electric motor actuators, meticulously designed to revolutionise the way you control slide valves. Our cutting-edge actuators are engineered with precision, offering a reliable and seamless solution for the opening, and closing of valves in various industrial applications.



### KEY FEATURES

#### Versatile Compatibility

OZB actuators are seamlessly compatible with both butterfly and slide valves, providing you with a versatile solution for a wide range of applications.

#### Manual, Pneumatic, and Electromotor Options

Tailor your valve control system to your specific needs with OZB actuators, available in manual, pneumatic, and electromechanical variants. Whether you prefer hands-on control, pneumatic precision, or the efficiency of an electromotor, OZB has you covered.

#### Complete Integration

ACES electric motor actuators come complete with an electromotor gearbox, shaft, and mounting elements. This all-in-one package ensures a hassle-free integration process, saving you time and effort during installation.



ABN: 35 139 258 816

PO Box 111, Charlestown NSW 2290  
Unit 7/8 Kilcoy Drive, Tomago NSW 2322  
P: 1300 026 011 | E: [graham@bulkquip.com.au](mailto:graham@bulkquip.com.au)  
[www.bulkquip.com.au](http://www.bulkquip.com.au)

## Reliable Performance

Trust in the robust design and engineering excellence of ACES electromechanical actuators. Our electric motor actuators are built to deliver reliable and consistent performance, ensuring the smooth operation of your valve systems.

## Precision and Accuracy

Experience unparalleled precision and accuracy in valve control with ACES actuators. Whether you're managing critical processes or fine-tuning your system for optimal performance, our actuators provide the control you need.

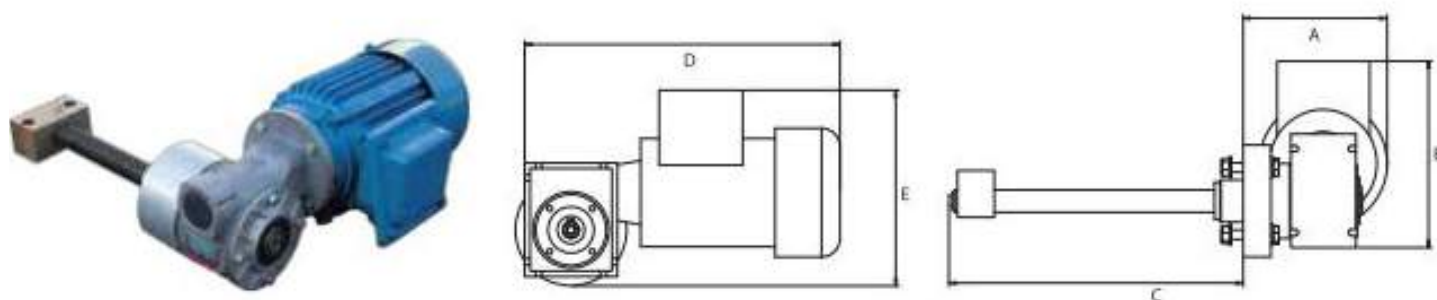

Type	Torque	Opening Time	Motor Power	Revolution	A (mm)	B (mm)	C (mm)	D (mm)	E (mm)
ACES150	16	13	0.25	140	165	195	225	335	210
ACES200	21	17	0.37	140	165	195	292	335	210
ACES250	21	21	0.37	140	165	195	317	335	210
ACES300	21	25	0.37	140	165	195	371	335	210
ACES350	21	30	0.37	140	165	195	432	335	210
ACES400	21	35	0.37	140	165	195	481	335	210