

OZB MS MICROSWITCH

The OZB MS Microswitch is designed for detecting the physical motion of valve shafts. These microswitches come equipped with a single-piece cam, providing easy adjustment, and reducing the risk of adjustment failures

Microswitches are commonly used in various industrial applications where a physical motion or position needs to be detected. The use of a single-piece cam in the OZB MS Microswitches likely simplifies the adjustment process and enhances the reliability of the switch in maintaining its set position.



KEY FEATURES

Type: OZB MS Microswitches

Application: Detection of the physical motion of valve shafts.

Key Feature: Single-piece cam design for easy adjustment and reduced risk of adjustment failures.

MS13

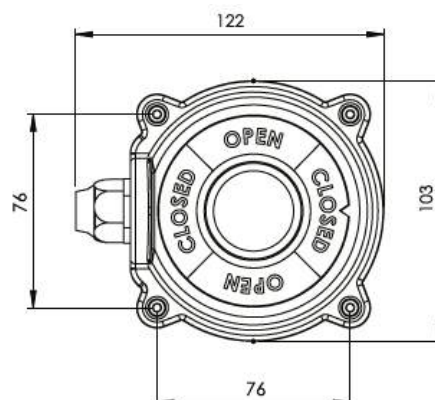
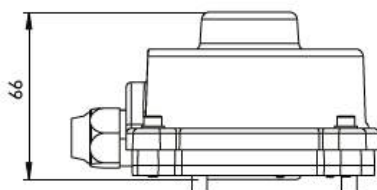

Designed for ACP13 pneumatic actuators.