



# Micro Dosing Units

OZB Micro Dosing Units are meticulously crafted for the precise transfer and dosing of bulk solids, specifically tailored for applications requiring low production capacity and sensitive dosing.

## FEATURES

With fixed revolution and capacity, these units are engineered to minimize bridge formation at the inlet area, ensuring consistent performance. They find extensive application in various industries, including pigment and additive dosing in ready mix concrete and building chemicals, as well as dosing and mixing in the food industry and powder and granule dosing in chemical and paint applications.

## Easy Maintenance

Designed for easy cleaning and maintenance, these micro dosing units are available in stainless steel, offering versatility in diameters of 114mm and 139mm. This technical excellence ensures efficient and precise bulk solid handling across diverse industrial sectors.



OZB Micro Dosing Units excel in the precise transfer and dosing of bulk solids, with fixed revolution and capacity to minimize bridge formation. Versatile applications span pigment and additive dosing in concrete and building chemicals, food industry dosing, and powder/granule dosing in chemicals and paint. Easy to clean and maintain, these units, available in stainless steel and diameters of 114mm and 139mm, stand out for their technical precision.

## CAPACITY

### Nominal capacities for units with drive group

Type	Motor Power (kW)	Capacity	
		Lt/rpm	Lt/hour
SCMD 114	0.37	0.2	450
SCMD 139	0.75	0.7	1500

### Nominal capacities for units without drive group

Type	Capacity Range (depending on drive group)	
	min	max
SCMD-BS 114	75	950
SCMD-BS 139	265	3000

## OVERALL DIMENSIONS

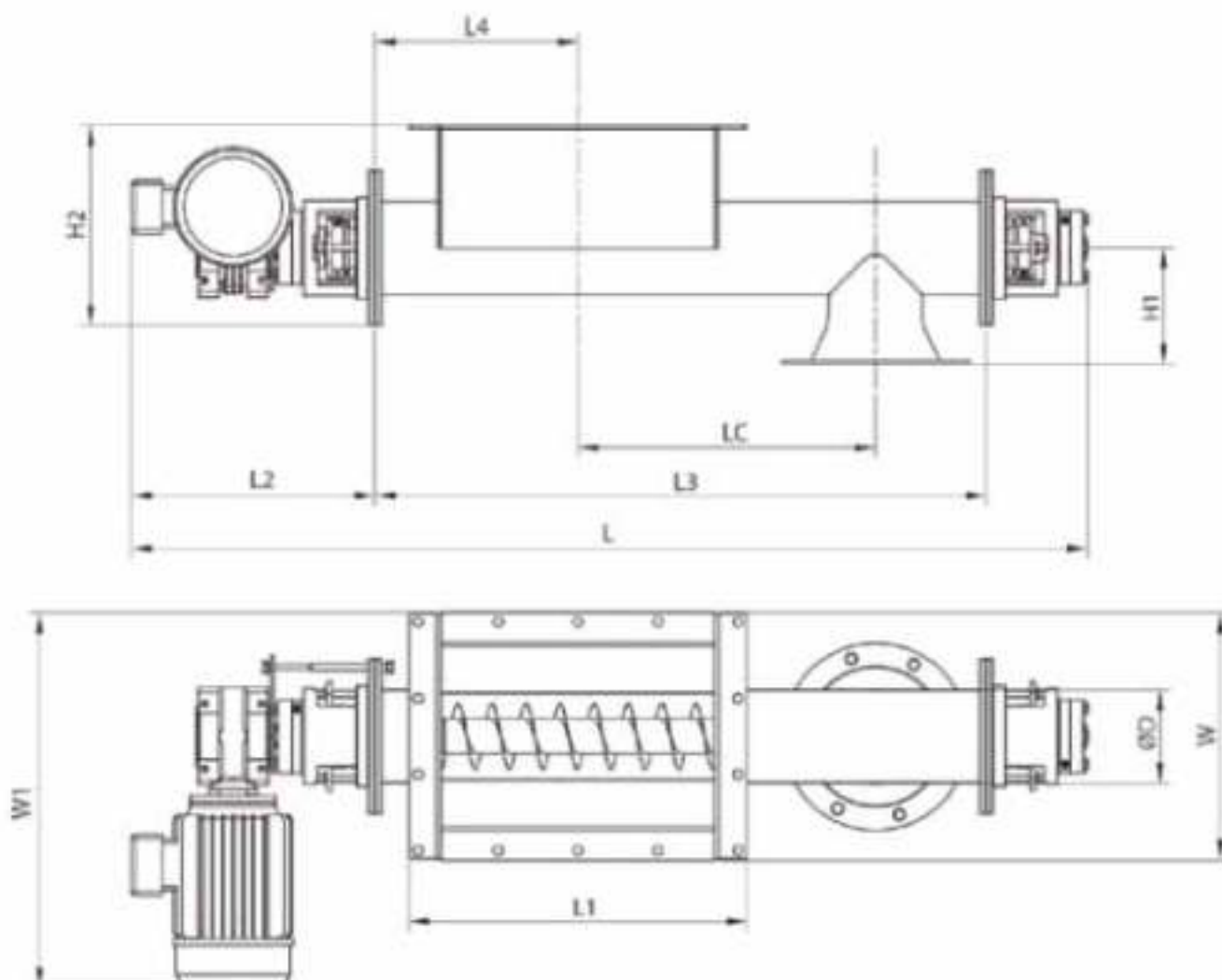

Type	L (mm)	L1 (mm)	L2 (mm)	L3 (mm)	L4 (mm)	LC (mm)	ØD (mm)	W (mm)	W1 (mm)	H1 (mm)	H2 (mm)	Weight (kg)
SCMD 114	1173	415	299	750	249	345	114	303	460	124	245	55
SCMD 139	1191	415	317	750	249	365	139	303	490	124	245	65